

Specifications:
 Current Rating: 1.0 Amp
 Contact resistance: 20MΩ Max
 Insulator resistance: 1000MΩ Min.
 Withstanding Voltage: 500V AC
 Operating Temperature Range: -40° ~ +105° C
 Material And Finish
 Insulator: Polyester, (PA6T UL94V-0)
 Insulator Color: Black
 Contact: Brass
 Contact Plated: See Contact Plated Tab.

Ordering information

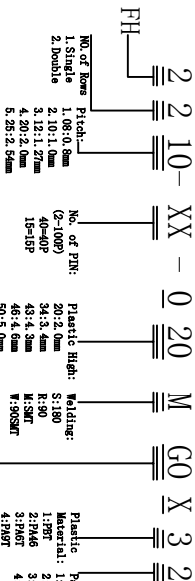

Code	Material	Finish	Plating	Material	Finish
00	load 100"	11	load 100"	11	Th. 100"
01	load 100"	12	load 100"	12	Th. 200"
02	load 100"	13	load 100"	13	Th. 150"
03	load 100"	14	load 100"	14	Th. 100"
04	load 100"	15	load 100"	15	Th. 100"
05	load 100"	16	load 100"	16	Th. 100"
06	load 100"	17	load 100"	17	Th. 100"
07	load 200"	18	load 200"	18	Th. 100"

未注公差 UNLESS OTHERWISE SPECIFIED TOLERANCE		线性 (LINER)		角度 (ANGLES)		品名 (TITLE):	
x ± --	x' ± 1'	.x ± 0.20	.x' ± --	.xxx ± 0.10	.xxx' ± --	FH1.0*2.0 2*N*P SMT 无柱 系列图	A4
第三视角投影 THIRD ANGLE PROJECTION		审核 (CHECK)		批准 (APPROVED)		料号 (PART NO.): 2210-XX020MGOX32	
日期 (DATE)		日期 (DATE)		版本 (REV)		单位 (UNIT) MM	
日期 (DATE)		日期 (DATE)		版本 (REV)		页次 (SHEET) 10F-1	



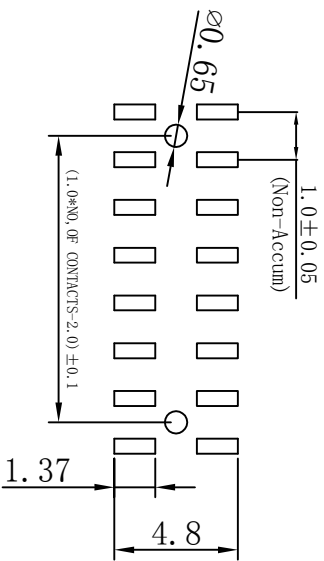
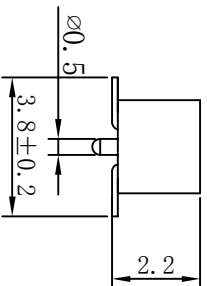
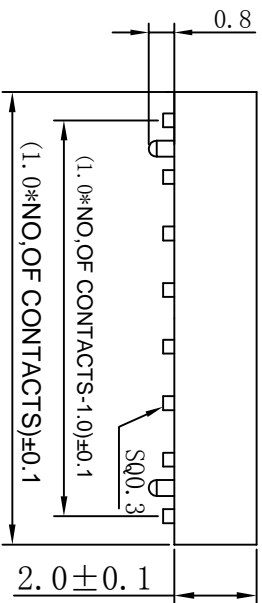
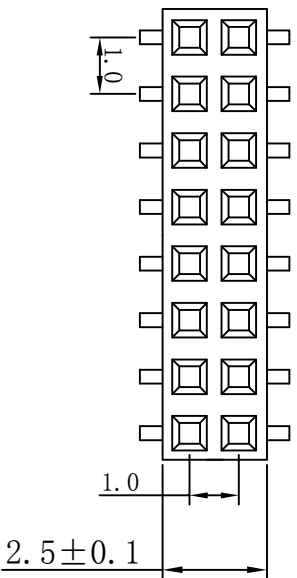

PCB LAYOUT

Specifications:
 Current Rating: 1.0 Amp
 Contact resistance: 20MΩ Max
 Insulator resistance: 1000MΩ Min.
 Withstanding Voltage: 500V AC
 Operating Temperature Range: -40° ~ +105° C
 Material And Finish
 Insulator: Polyester, (PA6T UL94V-0)
 Insulator Color: Black
 Contact: Brass
 Contact Plated: See Contact Plated Tab.

Ordering information

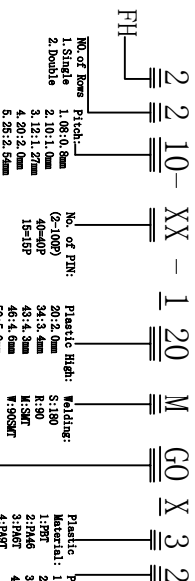

Code	Material	Finish	Plating	Notes
00	load 100"	11	load 100"	Th. 100"
01	load 100"	12	load 100"	Th. 100"
02	load 100"	13	load 100"	Th. 100"
03	load 100"	14	load 100"	Th. 100"
04	load 100"	15	load 100"	Th. 100"
05	load 100"	16	load 100"	Th. 100"
06	load 100"	17	load 100"	Th. 100"
07	load 100"	18	load 100"	Th. 100"



A4

未注公差 UNLESS OTHERWISE SPECIFIED TOLERANCE		品名 (TITLE):	
线性 (LINER)	角度 (ANGLES)	FH1.0*2.0 2*NP SMT 带柱 系列图	
.x ± 0.20	.x° ± 1°	绘图 (DRAWING)	料号(PART NO.): 2210-XX120MCOX32
.xx ± 0.15	.xx° ± --	审核 (CHECK)	图号(DWG NO.):
.xxx ± 0.10	.xxx° ± --	核准 (APPROVED)	比例(SCALE) 1:1
第三视角投影 THIRD ANGLE PROJECTION		日期 (DATE)	单位 (UNIT) MM
			页次(SHEET) 10F1